

AIM 2007 travel kit

- 1 Some important facts about AIM 2007
- 2 Travel information
- 3 The conference site
- 4 The banquet site
- 5 Restaurants at the conference site
- 6 Guidelines and equipment for presentations
- 7 Other useful information
- 8 Final program of AIM 2007

1 Some important facts about AIM 2007

Conference site

AIM 2007 will be held in the CHN building of ETH's main campus in down-town Zurich (see map and travel information in Section 2). All ETH buildings are absolutely smoke-free.

Important dates

Tuesday, September 4 th	Workshops & Tutorials
September 5 th – 7 th	Technical sessions
Wednesday, September 5 th	Welcome reception
Thursday, September 6 th	Banquet
Friday, September 7 th	Goodbye party

Opening hours of the registration desk

Monday, September 3 rd	17.00 – 18.00
Tuesday, September 4 th	08.00 – 18.30
Wednesday, September 5 th	08.00 – 18.30
Thursday, September 6 th	08.00 – 18.30
Friday, September 7 th	08.00 – 17.00

Phone, fax and e-mail at registration desk

Phone: +41 44 632 90 10

Fax: +41 44 632 90 11

E-mail: aim2007@ethz.ch

<http://aim2007.ethz.ch/>

2 Travel information

From Zurich Airport (Kloten)

After reclaiming baggage, follow the signs "Bahn/Railway" to ticket counters and machines. There are English instructions on the machines; follow them or simply press the left (red) key at the bottom where it says "Zurich City". The machine accepts coins as well as banknotes and gives change. The ticket is valid during the next hour for any train to Zurich as well as for the trams and buses in the city (streetcar / tram). Take an escalator down to the platforms 3 or 4. Trains to city centre leave approx. every 10 minutes and take about 10 minutes to reach Zurich main station (Zurich HB). You can also purchase a 24 hour ticket for all trains, trams, and buses in Zurich by making the appropriate selection on the machine. More info is available on <http://www.vbz.ch>.

You may also take a taxi directly to ETH Zentrum (the down-town campus). It costs around 50-60 sFr. However, during rush hour trains are faster and always cheaper.

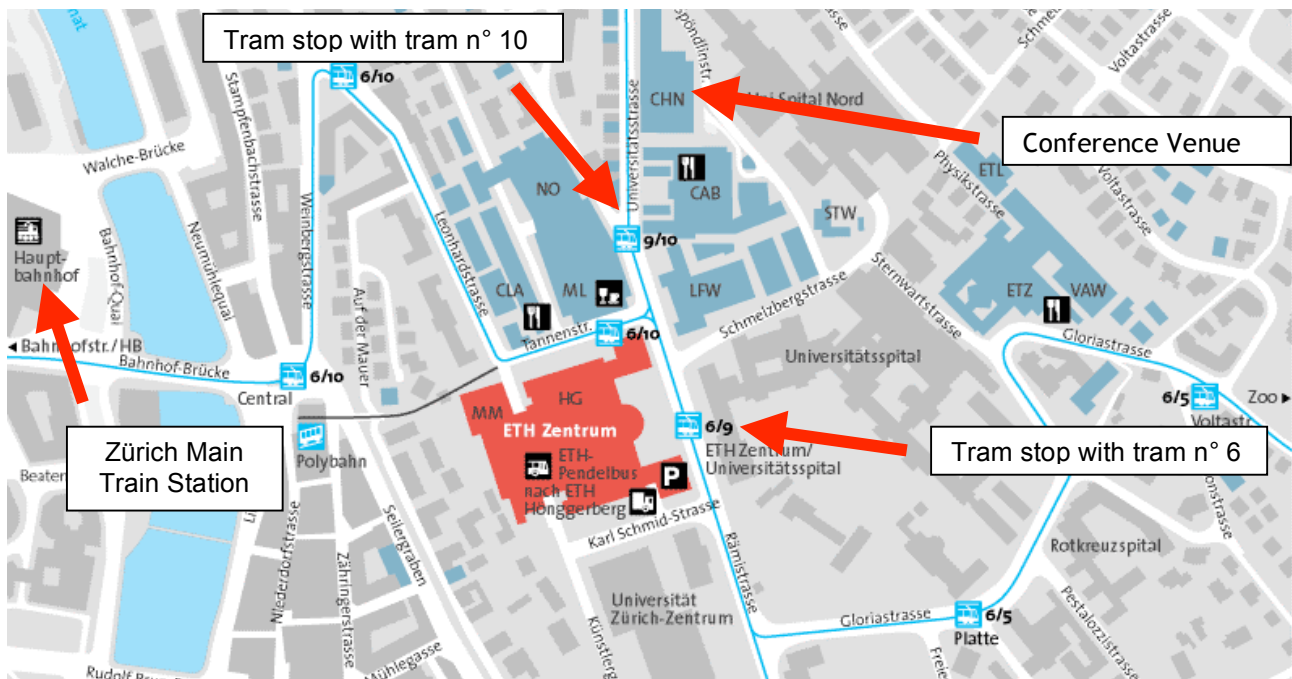

From Zurich Main Station

At the main station walk to the head of the train and follow any signs to "Bahnhofplatz" (tram 10, just next to main station) and "Bahnhofstrasse" (tram 6, around 100 m down the Bahnhofstrasse). If you arrived by train and haven't yet got a tram ticket, you must now buy one from the blue ticket machine. Depending on your needs, you can buy a day ticket which is valid for 24 hours for all trams and buses in the main zone (zone 10) of the city or, if all you need is to reach the ETH, press the yellow button.

From the main station you reach ETH Campus Zentrum in six minutes with tram no. 10 (direction *Bahnhof Oerlikon* or *Irchel* at night) from tram stop Bahnhofplatz or tram no. 6 (direction Zoo) from tram stop Bahnhofstrasse to the stop ETH/Universitätsspital (the 3rd stop).

You may also cross the Limmat river (2-3 minutes) and take the "Polybahn" at Central.



Public transportation

- You can find information about public transportation on the dedicated website: <http://www.vbz.ch/>. An English version is available (left, down).
- The following partial map shows the transportation network around the conference venue (ETH main campus)

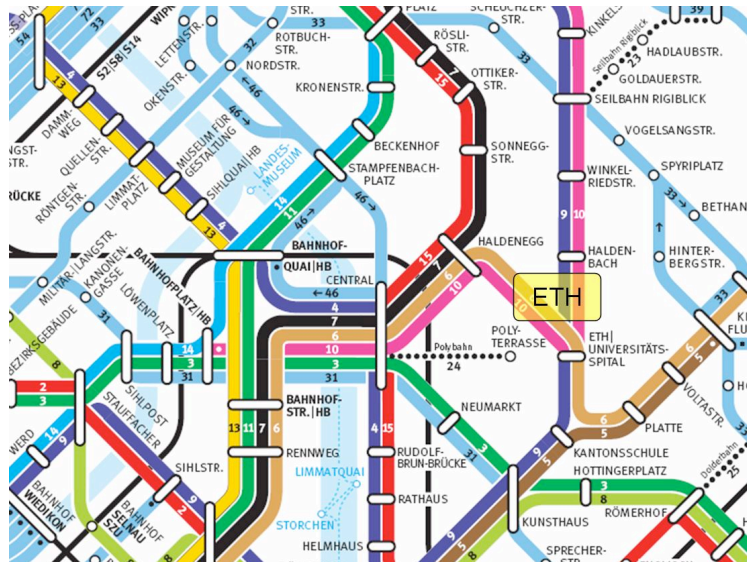

3 The conference site

AIM 2007 will be held in the CHN building of ETH's main campus in down-town Zurich. Four technical sessions will be held in parallel in rooms CHN E42, CHN E46, CHN F42 and CHN F46. The main entrance of this building is on floor E. However, the plenary sessions will be held in the HG building, room F30 called the Audimax. You will find signs to direct you on site.

CHN Building and HG building

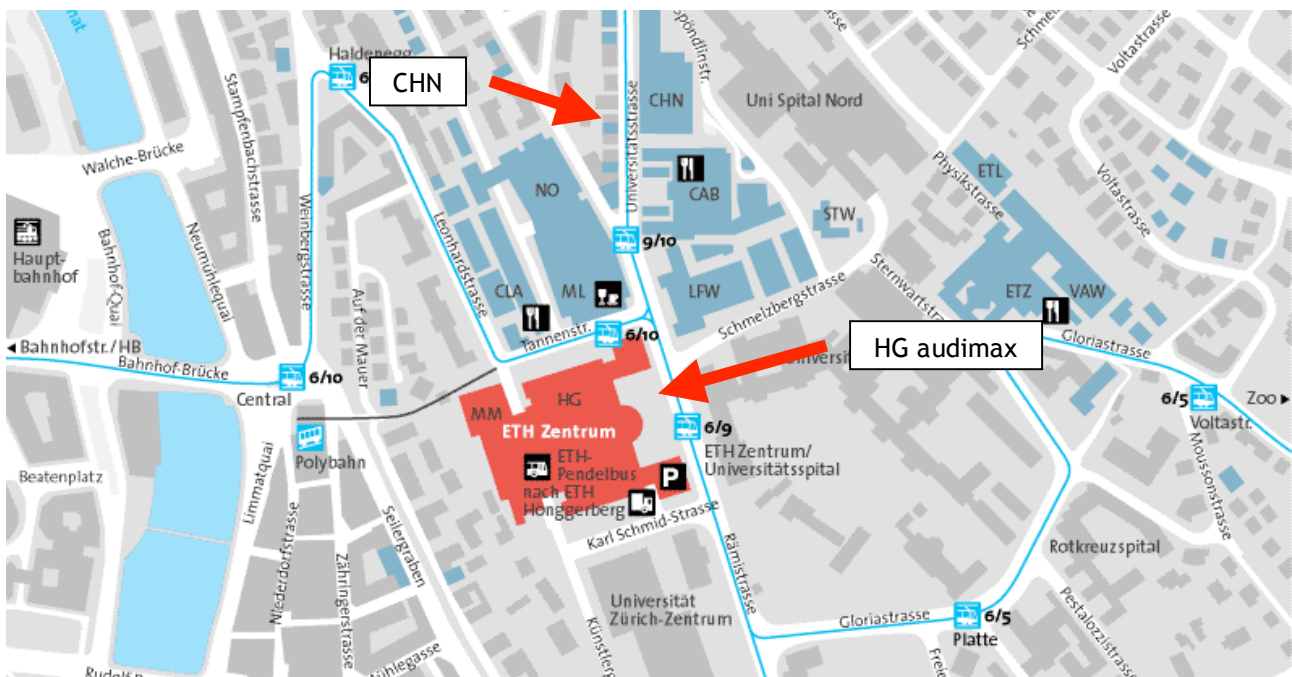

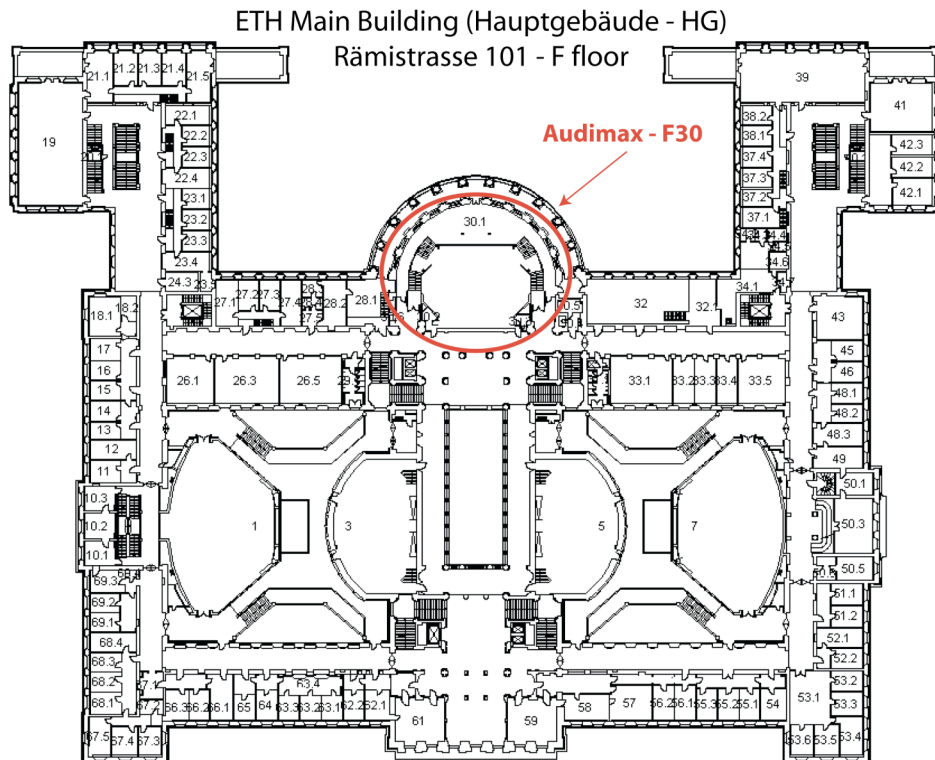

CHN Building - Floor D

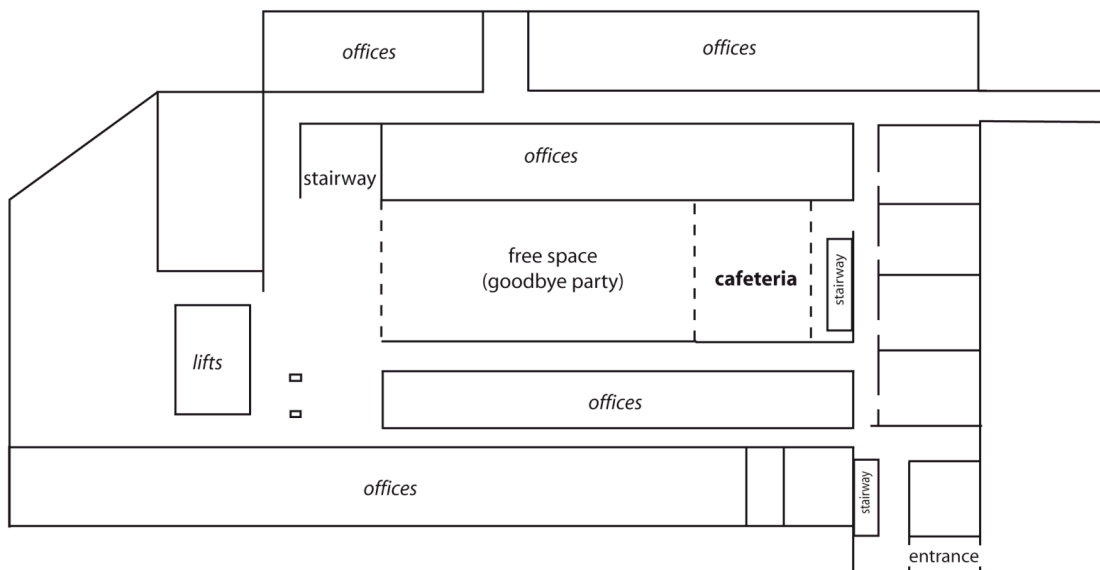

CHN Building - Floor E

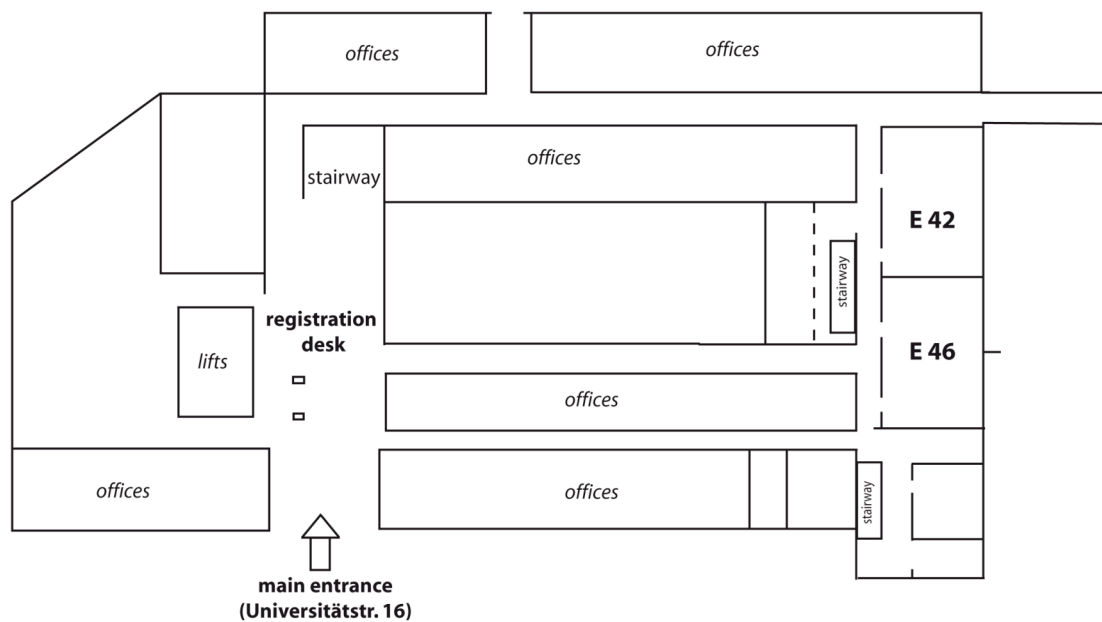

CHN Building - Floor F

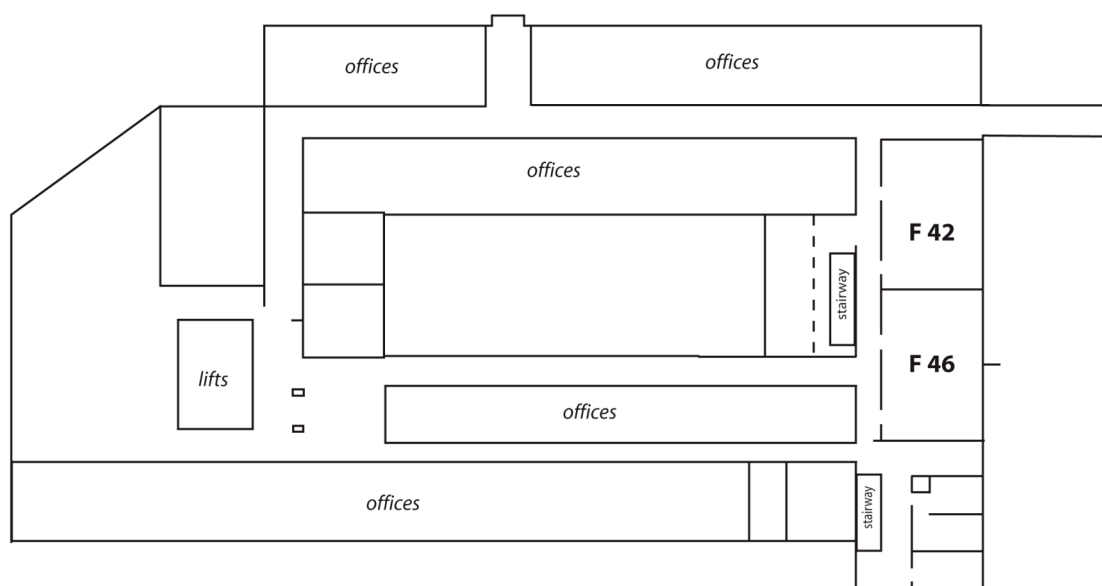

4 The banquet site

The banquet will be held on Thursday, September 6th, at hotel Uto Kulm, which is located on a small mountain called Uetliberg offering a panoramic view of the entire city of Zürich including the Lake.

How to get there

To reach the banquet location, you have to take a train from Zürich main station (Hauptbahnhof). You will get the train ticket at the registration desk with the rest of the material. This train is the **S10** from the special Sihltal – Zürich – Uetliberg (SZU) train line. It leaves from platform 2, which is located on the lower level of the main station at the southern edge of the area (see map below). A special train booked exclusively for AIM conference participants will leave the station at **19:16**. If unfortunately you would miss this train, regular trains are scheduled every half-hour (every 06 and 36 from 9:00 to 22:00) and take about 20 minutes to reach the final station: Uetliberg. To get back to Zürich after the banquet, you can take the same train, which leaves Uetliberg every 07 and 37 until 23:00 (last departure: 23:37, don't miss it!).

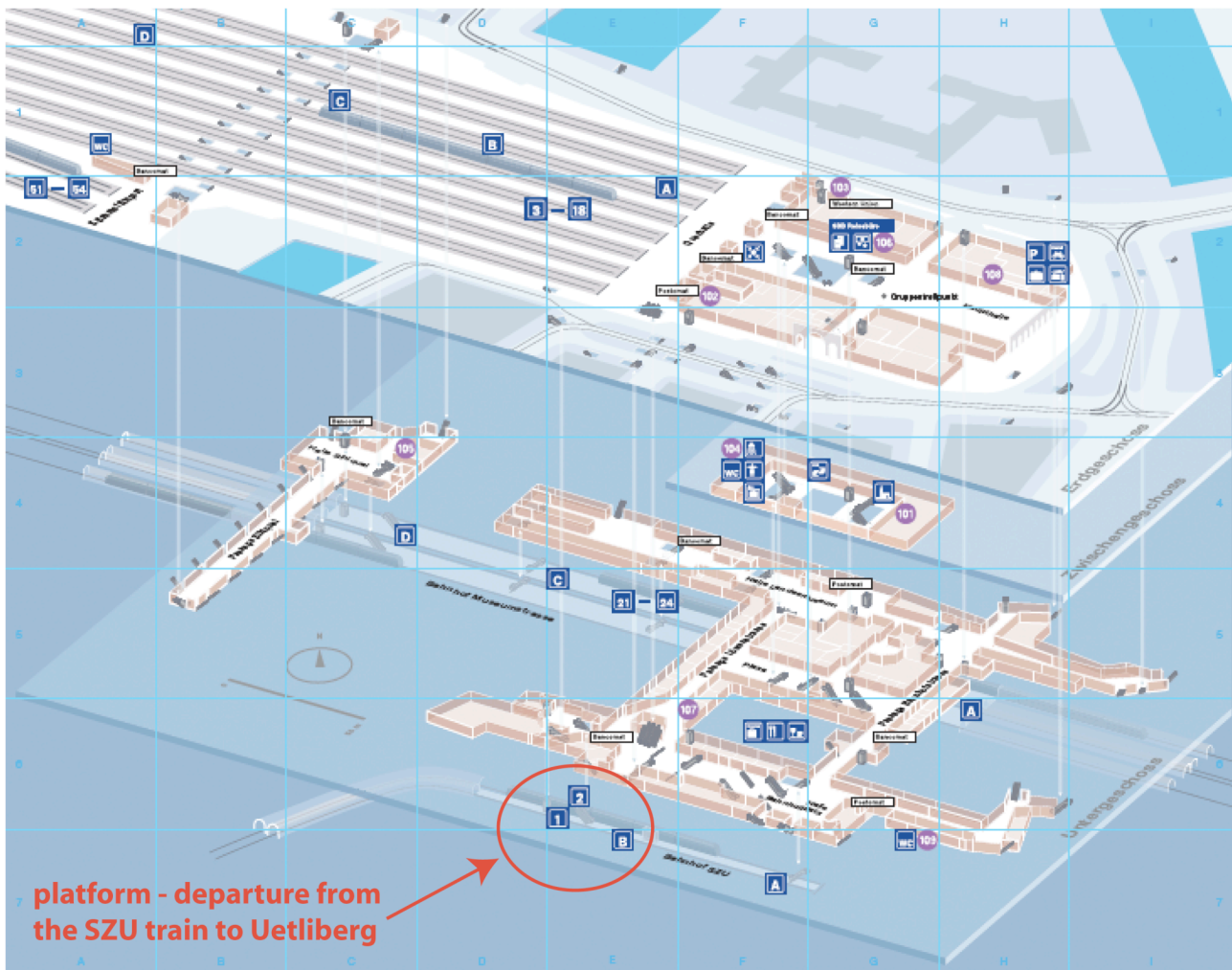

5 Restaurants at the conference site

There are various restaurants and snack bars on ETH Zentrum campus. The menu of the day costs around 11 sFr. Restaurants and snack bars are listed below and are indicated on the map. You can find more information on the following website: <http://www.mensa.ethz.ch/>.

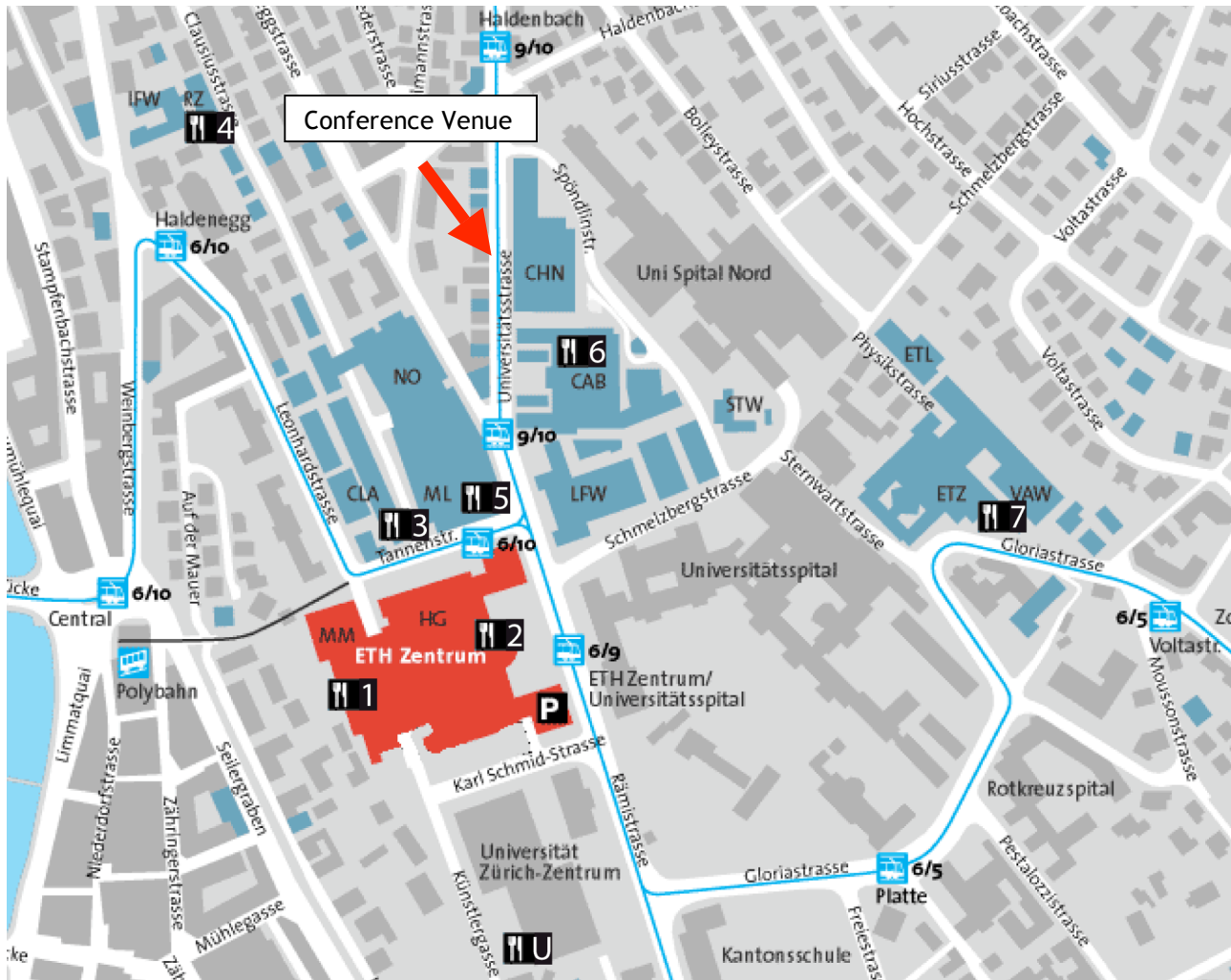

	Name	Building	Adresse
1	Polyterrasse Mensa	MM	Leonhardstrasse 34
	Polyterrasse Cafeteria	MM	Leonhardstrasse 34
2	Poly-Snack	HG	Rämistrasse 101
3	Clausiusbar	CLA	Tannenstrasse 3
4	Informatikbar	IFW/RZ	Haldeneggsteig 4
5	Tannenbar	ML	Tannenstrasse
6	Restaurant CAB	CAB	Universitätsstrasse 6
7	Gloriabar	ETZ	Gloriastasse 35
U	Mensa der Universität Zürich	Universität	Künstlergasse 10

6 Guidelines and equipment for presentations

- **Please contact your chairman 10 minutes before the start of your session.**
- Each presentation is scheduled for a 15 minutes talk and 5 minutes of discussion. Please prepare your presentation accordingly.
- Each presentation room will be equipped with an overhead projector and a beamer for presenting from your own laptop. If you need specific equipment, please inform us well in advance (AIM2007@ethz.ch).
- We will have an AIM staff member (red T-shirt) in each presentation room to help you with all technical and organizational issues.
- Please inform us as soon as possible if you have any problem with your presentation time.

7 Other useful information

Climate

- The climate in Switzerland is usually pretty nice in early September with little rain. You should expect temperatures around 20° C during the day and around 10° C at night. Early September is still a good season for hiking, sightseeing and other outdoor activities. With a little luck, you will even be able to enjoy swimming in the Limmat river (e.g., at the Flussbad Oberer Letten).

Sightseeing in Zürich and Switzerland

- Zürich offers various attractions and museums and has a nice down-town shopping area. Here are some highlights:
 - Kunsthaus – Switzerland's most important art gallery contains a collection from all the important periods of European art – from the Middle Ages through to the present.
 - Rietberg Museum – the museum houses non-European art, particularly from India, China and Africa.
 - Bahnhofstrasse – the mile-long street of banks featuring exclusive fashion boutiques is the place to go shopping.
 - Zurich Zoo – Tram 6 will take you uphill to get a beautiful view of Zürich City, with the possibility to take a very nice walk to the impressive Zurich Zoo.
 - Old town – full of art galleries, antique and book shops, roaming in the old town is a pleasant way to discover the historical side of Zurich.
 - Niederdorf - during the day this is a pedestrian zone and a shopper's paradise with lots of boutiques hidden away in a patchwork of alleys. At night the many bars, restaurants and street artists turn the Niederdorf into an exciting and colorful center of entertainment.
- Finally, September is still a good season for hiking and Zürich can be considered as the gateway to the Alps. For more information please have a look to the tourist office web site: <http://www.zuerich.com>. Further information will also be available at the registration desk or at your hotel.

8 Final program of AIM 2007

2007 IEEE / ASME International Conference on Advanced Intelligent Mechatronics September 4 - 7, ETH Zurich

Workshop & Tutorials, September 4, 2007

Time	Audi Max	CHN E42	Place CHN E 46	CHN F42	CHN F46
morning		Workshop on Higher Education in Mechatronics			
afternoon			Workshop on Next Generation Machines	Tutorial on Rapid Prototyping of GNC Algorithms	Tutorial on Nanobiotechnology for mechatronics

Technical Sessions, September 5, 2007

Time	Audi Max	CHN E42	Place CHN E 46	CHN F42	CHN F46
09.00 - 09.10	Welcome				
09.10 - 09.50	Plenary Talk				
10.00 - 11.00		Modular Robots	SMA Actuators	Diagnosis & Failure Managment	Manipulators
11.00 - 11.20		Coffee Break			
11.20 - 12.20		Machine Vision I	Human-Machine Interaction I	Sensing I	Flexible Manipulators I
12.20 - 13.40		Lunch Break			
13.40 - 15.00		Machine Vision II	Design and Prototyping	Teleoperation	Dual Arm / Cooperative
15.00 - 15.20		Coffee Break			
15.20 - 16.40		Electromagnetic Devices I	Actuators	Rehabilitation Robotics	Parallel Manipulators I
16.50 - 18.10		Electromagnetic Devices II	Haptic Interaction	Sensing II	Parallel Manipulators II
18.15	welcome reception in Hall of CHN Building				

Technical Sessions, September 6, 2007

Time	Audi Max	CHN E42	Place CHN E 46	CHN F42	CHN F46
08.30 - 09.10	Plenary Talk				
09.20 - 10.40		Microactuators	Nonlinear and Adaptive Control I	Transportation Systems I	Robot Locomotion I
10.40 - 11.00		Coffee Break			
11.00 - 12.20		Micro/Nano Devices	Nonlinear and Adaptive Control II	Transportation Systems II	Robot Locomotion II
12.20 - 13.40		Lunch Break			
13.40 - 15.00		Micro/Nano Manipulation	Nonlinear and Adaptive Control III	Transportation Systems III	Robot Locomotion III
15.00 - 15.20		Coffee Break			
15.20 - 16.40		Microassembly / Fabrication	Nonlinear and Adaptive Control IV	Navigation and Planning I	Robust/Optimal Control I
16.50 - 18.10		Sensor Networks / Fusion	Piezoelectric Devices	Navigation and Planning II	Robust/Optimal Control II
19.00	Conference Banquet (Start from Zurich Main Station)				

Technical Sessions, September 7, 2007

Time	Audi Max	CHN E42	Place CHN E 46	CHN F42	CHN F46
08.30 - 09.10	Plenary Talk				
09.20 - 10.40		Medical Devices and Systems	Robotic Hands / Finger	Multi-Robot Systems	Mobile Robot Localization I
10.40 - 11.00		Coffee Break			
11.00 - 12.20		Flexible Manipulators II	Redundant Manipulators	Helicopters	Mobile Robot Localization II
12.20 - 13.40		Lunch Break			
13.40 - 15.00		Precision Mechatronics	Human-Machine Interaction	Control Technology	Mobile Robot Localization III
15.00 - 15.20		Coffee Break			
15.20 - 16.40		Bipedal Robots	Industrial Robotics	Human Supervisory Control	Manipulators II
16.50 - 18.30	Goodbye Party in Hall of CHN Building				